

# STAINLESS STEEL X CONDUIT BODIES

## Features:

- Manufactured in type 316 stainless steel to meet any stringent sanitary condition
- Polished with standard “brite” finish to increase corrosion resistance and aesthetic appearance
- Solid stainless construction permits easy installation using ordinary hand tools
- The flat back design allows extra wiring capacity
- No package quantity required
- Cover and Gasket set included
- Form 8 style

## Certifications and Compliances:

- UL / cUL 514A Listed
- UL File # E307133
- Article 314 of ANSI/NFPA 70, National Electrical Code (NEC)
- Approved for wet locations, IP69 Rated
- NSF/ANSI 169 Certified

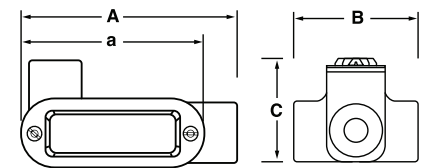

## Features:

- Body: 316SS
- Gasket: Neoprene
- Cover and Screws: 316SS

## Applications:

To connect and change direction of conduit runs. Can be used as pulling fittings. Accessible wiring chamber provides a spacious location to make splices.



| Part Number | Trade Size (in) | A (in) | B (in) | C (in) | a (in) | Cubic Inches (in) | Weight per each (lb) |
|-------------|-----------------|--------|--------|--------|--------|-------------------|----------------------|
| S60500XB00  | ½               | 5.994  | 2.944  | 2.050  | 4.320  | 5                 | 1.44                 |
| S60700XB00  | ¾               | 6.538  | 3.398  | 2.300  | 4.950  | 9                 | 2.04                 |
| S61000XB00  | 1               | 7.690  | 3.910  | 2.450  | 5.650  | 13                | 2.79                 |
| S61200XB00  | 1¼              | 8.780  | 4.300  | 2.825  | 6.600  | 24                | 4.24                 |
| S61500XB00  | 1½              | 9.923  | 4.640  | 3.060  | 7.810  | 35                | 5.41                 |
| S62000XB00  | 2               | 12.554 | 5.810  | 3.700  | 10.000 | 77                | 9.45                 |

All dimensions are for informational purposes only \*Tolerances +/- 5%

