

STAINLESS STEEL BULLET HUBS

Features:

- Manufactured in type 316 stainless steel to meet any stringent sanitary condition
- Polished with standard “brite” finish to increase corrosion resistance and aesthetic appearance
- Designed for use with stainless threaded conduit
- Use of neoprene O-ring assures weatherproof seal
- Includes a type 316 stainless steel locknut for a secure installation
- No package quantity required

Applications:

To connect threaded stainless conduit to a threadless opening in a box or enclosure in an outdoor or indoor location. To positively bond conduit to a box or enclosure.

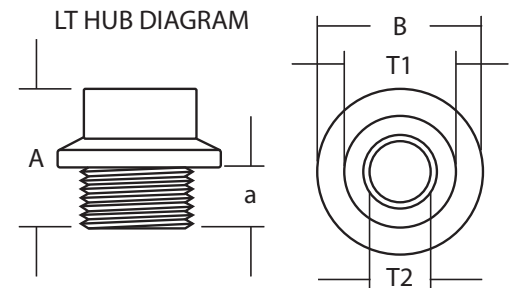

Part Number	Trade Size (in)	A (in)	B (in)	a (in)	T1 (in)	T2 (in)	Male Thread OD (in)	Weight per each (lb)
S60500LTV1	1/2	1.670	1.700	0.620	1.100	0.750	0.840	0.390
S60700LTV1	3/4	1.680	1.930	0.675	1.350	0.960	1.050	0.530
S61000LTV1	1	2.070	2.200	0.830	1.600	1.210	1.315	0.750
S61200LTV1	1 1/4	2.060	2.560	0.850	1.960	1.560	1.660	0.970
S61500LTV1	1 1/2	2.080	2.800	0.870	2.200	1.800	1.900	1.170
S62000LTV1	2	2.100	3.320	0.875	2.730	2.290	2.375	1.650
S62500LTV1	2 1/2	2.720	3.800	0.950	3.310	2.730	2.875	2.250
S63000LTV1	3	2.910	4.500	0.975	3.860	3.350	3.500	3.000
S64000LTV1	4	3.190	5.500	1.090	5.000	4.360	4.500	4.860

All dimensions are for informational purposes only *Tolerances +/- 5%

