

# STAINLESS STEEL X CONDUIT BODY

## Features:

- The four-hub "X" configuration limits the amount of additional fittings needed on a project as wires can be fed through and then out in several directions to simplify installation.
- Manufactured in Type 316 stainless steel to meet any stringent sanitary condition
- Polished with standard "brite" finish to increase corrosion resistance and aesthetic appearance
- Solid stainless construction permits easy installation using ordinary hand tools
- The flat back design allows extra wiring capacity
- No minimum package qty. required
- Cover and Gasket set included
- Form 8 style

## Materials:

- Body - 316SS
- Gasket - Neoprene
- Cover and Screws - 316SS

## Applications:

To connect and change direction of conduit runs. Can be used as pulling fittings. Accessible wiring chamber provides a spacious location to make splices.

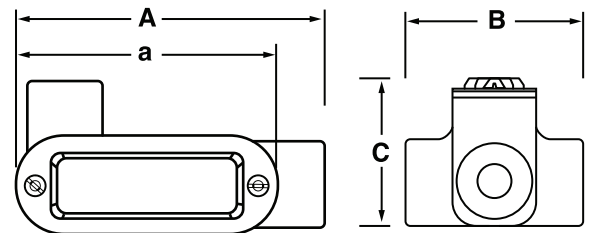

Part Number	Trade Size (in)	A (in)	B (in)	C (in)	a (in)	Cubic Inches (in)	Weight each per (lb)
S60500XB00	½	5.994	2.944	2.050	4.320	5	1.350
S60700XB00	¾	6.538	3.398	2.300	4.950	9	1.800
S61000XB00	1	7.690	3.910	2.450	5.650	13	2.700
S61500XB00	1½	9.923	4.640	3.060	7.810	35	4.850
S62000XB00	2	12.554	5.810	3.700	10.000	77	9.350

All dimensions are for informational purposes only \*Tolerances +/- 5%



For more info visit [atkore.com/calbrite](http://atkore.com/calbrite)

