

STAINLESS STEEL TWO HOLE STRAPS

Features:

- Manufactured in type 316 stainless steel to meet any stringent sanitary condition
- Polished with standard “brite” finish to increase corrosion resistance and aesthetic appearance
- Designed for use with stainless rigid, stainless IMC, galvanized and aluminum conduit
- No package qty. required

Certifications and Compliances:

- Calbrite stainless steel One Hole Straps are fabricated to meet ANSI/UL standards
- Complies with Manufacturers' Standardization Society (MSS) SP-58 & SP-69 (Type 1)
- Complies with Federal Specifications A A-1192A (Type 1)
- Complies with Underwriters' Laboratories (UL) & (cUL) (20140603-EX15800)
- Load capacity: 1/2" - 2" trade sizes = 275 lbs, 2-1/2" - 4" trade sizes = 500 lbs

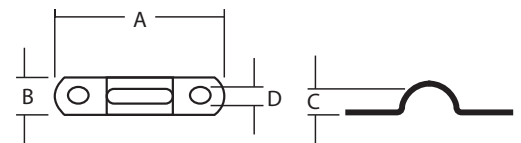

Applications:

Heavy duty type 316 stainless steel one-hole mount straps are great for securing and mounting conduit, tubing and cable in corrosive environments.

Part Number	Trade Size (in)	A (in)	B (in)	C (in)	Bolt Hole Size (in)	Weight each per (lb)
S605002S00	1/2	2.630	0.630	0.840	1/4	0.020
S607002S00	3/4	2.930	0.750	1.050	1/4	0.030
S610002S00	1	3.380	0.750	1.300	1/4	0.040
S612002S00	1 1/4	4.350	0.820	1.660	1/4	0.060
S615002S00	1 1/2	4.440	1.240	1.900	1/4	0.130
S620002S00	2	5.300	1.250	2.370	1/4	0.170
S625002S00	2 1/2	5.750	1.250	2.870	1/4	0.200
S630002S00	3	6.800	1.250	3.500	1/4	0.230
S640002S00	4	9.75	1.250	4.500	1/4	0.280

All dimensions are for informational purposes only *Tolerances +/- 5%



For more info visit atkore.com/calbrite

