

STAINLESS STEEL 1 5/8" X 7/8" SOLID STRUT

Features:

- Manufactured in both type 304 and 316 stainless to meet any stringent sanitary condition
- Polished to a bright, easily maintainable finish that is modern, attractive, easy to clean, and that also enhances the surface's resistance to pitting and bacterial corrosion
- Calbrite stainless steel strut functions in exactly the same way as any other metallic strut
- Channels provided by Calbrite are available in 12 different basic sizes which are subjected to further variation in gauge and depth



Certifications and Compliances:

- UL 5B Listed
- For installation in accordance with Article 384 of ANSI/NFPA 70, National Electrical Code (NEC)

Applications:

The Calbrite system of metal framing is based on the use of a continuous slotted channel, and a series of brackets and fittings, which can be fastened to it any point. With Calbrite channel and components, racks, supports for conduit, wiring, electrical equipment, machine frames, and a limitless variety of structures can be built rapidly, simply and economically.

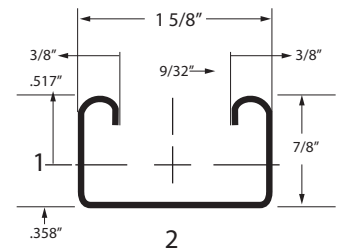

14 Gauge

Industries Commonly Served:

- Food & Beverage Production
- Marine & Coastal Facilities
- Chemical Plants
- Water & Wastewater Treatment
- Pharmaceuticals & Cosmetics
- Refining & Extraction Sites
- Petrochemical Operation
- Pulp & Paper Mills
- Along with other corrosive environments

Type 304 Part Number	Type 316 Part Number	Size (in)	Height of Lip (in)	Width of Lip (in)	Sectional Area (in ²)	Weight each per L.F. (lb)
S45810SL78	S65810SL78	1 5/8 X 7/8	9/32	3/8	0.285	1.00

All dimensions are for informational purposes only *Tolerances +/- 5%



For more info visit atkore.com/calbrite

