

STAINLESS STEEL SEALING LOCKNUTS



Features:

- Manufactured in type 316 stainless steel to meet any stringent sanitary condition
- Polished to a bright, easily maintainable finish that is modern, attractive, easy to clean, and that also enhances the surface's resistance to pitting and bacterial corrosion
- Heavy-duty locknut bites into the box and enclosure to prevent vibratory loosening of the connection
- Integrally fused PVC gasket provides positive seal against water, oils and other liquids
- Designed for use with rain tight, watertight, and oil tight enclosures
- NPSL – straight threads
- No package qty required

Certifications and Compliances:

- Manufactured to meet UL 514B standards

Applications:

For use on threaded stainless rigid/IMC conduit to provide a seal against water and oil.

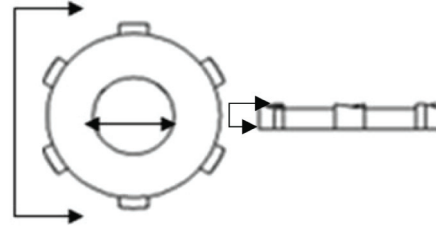

Industries Commonly Served:

- Food & Beverage Production & Distribution
- Chemical Plants
- Water & Wastewater Treatment
- Pharmaceuticals & Cosmetics
- Refining & Extraction Sites
- Petrochemical Operations
- Pulp & Paper Mills
- Along with other corrosive environments

Part Number	Trade Size	A	I.D.	Wall Thickness	Weight each per lb.
S60500LNWS	1/2"	1.250"	0.760"	0.227"	0.02
S60700LNWS	3/4"	1.450"	0.975"	0.260"	0.03
S61000LNWS	1"	1.820"	1.210"	0.294"	0.06
S61200LNWS	1-1/4"	2.210"	1.570"	0.308"	0.08
S61500LNWS	1-1/2"	2.450"	1.810"	0.325"	0.09
S62000LNWS	2"	2.915"	2.300"	0.342"	0.10

*All dimensions are for informational purposes only *Tolerances +/- 5%*