



STAINLESS STEEL HEX NUTS

Features:

- Manufactured in type 316L stainless steel to meet any stringent sanitary condition
- Polished with standard "brite" finish to increase corrosion resistance and aesthetic appearance
- Designed for use with stainless rigid & IMC, aluminum, galvanized, & PVC coated conduit
- Includes two type 316L stainless steel bolts
- No package quantity required

Certifications and Compliances:

- Manufactured to ASTM standards

Applications:

Calbrite's stainless steel Split Ring Clamps are designed for mounting & securing conduit, horizon from the wall or device in wash-down or corrosive environments.

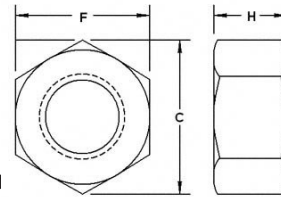

Industries Commonly Served:

- Food & Beverage Production & Distribution
- Chemical Plants
- Water & Wastewater Treatment
- Pharmaceuticals & Cosmetics
- Refining & Extraction Sites
- Petrochemical Operations
- Pulp & Paper Mills
- Along with other corrosive environments

Part Number	Trade Size	C	F	H	F	Weight each per lb.
S60200HN00	1/4"	0.500"	0.420"	0.220"	0.250"	0.01
S60300HN00	3/8"	0.625"	0.550"	0.330"	0.375"	0.01
S60500HN00	1/2"	0.850"	0.750"	0.430"	0.500"	0.03
S60600HN00	5/8"	1.050"	0.900"	0.550"	0.625"	0.07

*All dimensions are for informational purposes only *Tolerances +/- 5%*