

Calbrite™

Stainless Steel Conduit Systems

Stainless Steel Locknuts

Features:

- Made from Type 316 stainless steel for increased corrosion resistance
- Polished with standard "brite" finish to increase corrosion resistance and aesthetic appearance
- No package qty. required



Certifications and Compliances:

UL514B approved – file # E308159

All Locknuts are intended to be installed in accordance with ANSI/NFPA 70, "National Electrical Code" (NEC)

Applications:

Used to connect threaded conduit or connector to a threadless opening in a box, enclosure, or fitting. Heavy stock thickness and specially designed tabs tighten securely and will not easily loosen even in the most severe applications.

Industries Commonly Served:

- Food & Beverage Production & Distribution
- Chemical Plants
- Water & Wastewater Treatment
- Pharmaceuticals & Cosmetics
- Refining & Extraction Sites
- Petrochemical Operations
- Marine & Coastal Facilities
- Pulp and Paper Mills
- Along with other corrosive environments

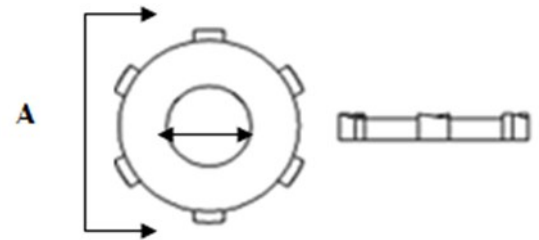

Size	Part Number	A	I.D.	Wall Thickness	Weight (ea) per lb.
1/2"	S60500LN00	1.24"	0.79"	.138"	0.02
3/4"	S60700LN00	1.43"	0.975"	.168"	0.03
1"	S61000LN00	1.80"	1.22"	.205"	0.05
1-1/4"	S61200LN00	2.18"	1.56"	.216"	0.07
1-1/2"	S61500LN00	2.42"	1.80"	.216"	0.08
2"	S62000LN00	2.89"	2.29"	.233"	0.10
2-1/2"	S62500LN00	3.56"	2.76"	.236"	0.17
3"	S63000LN00	4.20"	3.42"	.236"	0.19
4"	S64000LN00	5.23"	4.39"	.236"	0.23

*All dimensions are for informational purposes only *Tolerances +/- 5%*