

Calbrite™

Stainless Steel Conduit Systems

Stainless Steel 3 Piece Couplings

Features:

- Manufactured in type 316 stainless steel for increased corrosion resistance
- Polished with standard "brite" finish to increase corrosion resistance and aesthetic appearance
- Machined tapered female threads for smooth bore inside diameter
- No package qty. required

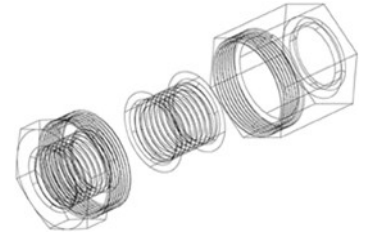

Certifications and Compliances:

Calbrite stainless steel 3 Piece Couplings are fabricated to UL Standards

Applications:

To join and connect threaded ends of stainless conduit where neither length of conduit can be turned.

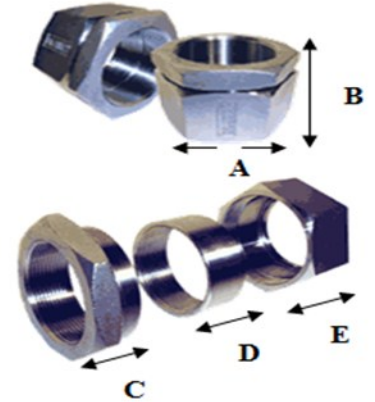

Industries Commonly Served:

- Food & Beverage Production & Distribution
- Chemical Plants
- Water & Wastewater Treatment
- Pharmaceuticals & Cosmetics
- Refining & Extraction Sites
- Petrochemical Operations
- Marine & Coastal Facilities
- Pulp and Paper Mills
- Along with other corrosive environments

Size	Part Number	A	B	C	D	E	Female Thread I.D.	Weight (ea) per lb.
½"	S605003U00	1.510"	1.680"	0.800"	0.750"	1.240"	0.770"	.44
¾"	S607003U00	1.790"	1.750"	0.810"	0.770"	1.305"	0.980"	.58
1"	S610003U00	2.150"	2.130"	1.030"	0.975"	1.580"	1.240"	.94
1-1/2"	S615003U00	2.870"	2.150"	1.030"	1.000"	1.600"	1.820"	1.47
2"	S620003U00	3.520"	2.240"	1.040"	1.000"	1.680"	2.300"	2.27

*All dimensions are for informational purposes only *Tolerances +/- 5%*