

Calbrite™

Stainless Steel Conduit Systems

Stainless Steel Two Hole Straps

Features:

- Manufactured in type 316 stainless steel to meet any stringent sanitary condition
- Polished with standard "brite" finish to increase corrosion resistance and aesthetic appearance
- Designed for use with stainless rigid, stainless light wall, galvanized, & aluminum conduit
- No package qty. required



Certifications and Compliances:

Calbrite stainless steel two hole straps are fabricated to UL and ASTM 167 standards. Manufactured in the United States

Applications:

Heavy duty type 316 stainless steel two-hole mount straps are great for securing and mounting conduit, tubing, & cable in corrosive environments.

Industries Commonly Served:

- Food & Beverage Production & Distribution
- Chemical Plants
- Water & Wastewater Treatment
- Pharmaceuticals & Cosmetics
- Refining & Extraction Sites
- Petrochemical Operations
- Marine & Coastal Facilities
- Pulp and Paper Mills
- Along with other corrosive environments

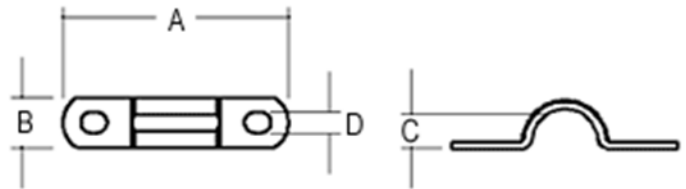

Size	Part Number	A	B	C	Bolt Hole Size (D)	Weight (ea) per lb.
1/2"	S605002S00	0.625"	0.075"	0.840"	1/4"	0.03
3/4"	S607002S00	0.750"	0.090"	1.050"	1/4"	0.05
1"	S610002S00	0.875"	0.090"	1.300"	1/4"	0.06
1-1/4"	S612002S00	0.875"	0.100"	1.660"	3/8"	0.11
1-1/2"	S615002S00	1.000"	0.125"	1.900"	3/8"	0.17
2"	S620002S00	1.125"	0.125"	2.370"	3/8"	0.22
2-1/2"	S625002S00	1.250"	0.150"	2.874"	9/16"	0.55
3"	S630002S00	1.250"	0.150"	3.500"	9/16"	0.64
4"	S640002S00	1.250"	0.180"	4.500"	9/16"	0.76

All dimensions are for informational purposes only *Tolerances +/- 5%